

Addendum VLINE

TOY6VL2 2010-2014 Select Toyota/Lexus Vehicles

The VLINE is able to be display on the stereo's screen by pretending to be a Reverse Camera Image. For this particular vehicle setup, if equipped with Original Factory Reverse Camera, will be disabled unless one additional wire is tapped for the VLINE to understand when the Gear Selector is in Reverse so that it can disengage itself from the Display so that the original Reverse Camera image can come through.

Installation:

Tap PURPLE wire labeled REV from the supplied interface cable to Reverse Wire in the vehicle. This wire can be found on connector behind the original Display in the vehicle.

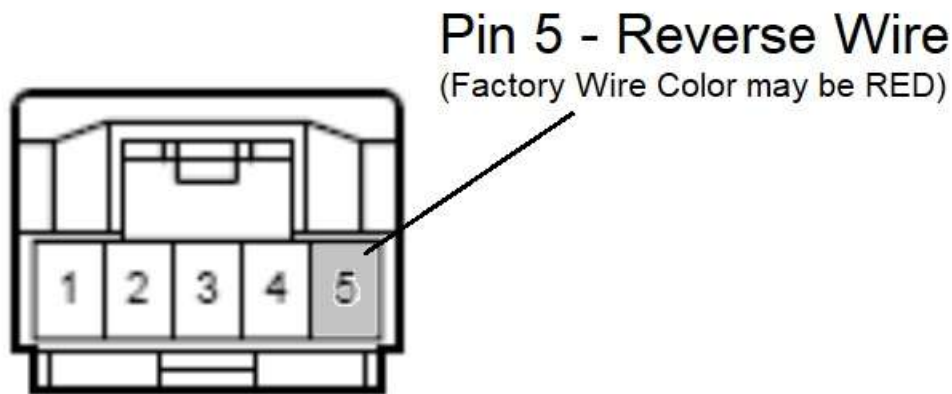

Viewed as Connector Side

1. Locate PIN 5 (Reverse Wire) on original 5-PIN connector at the rear of the Display (See connector view above for reference of Reverse wire location)

(This is a guide to locate the wire. Please test the wire to confirm before making connection. If you are not comfortable making connection, Please seek professional installation.)

2. Use the supplied RED Posi-Tap to make connection.

IMPORTANT: It is always best to test this wire before tapping to make sure it is REVERSE wire and not something else. The reverse wire in the vehicle will show 12 Volts (DC) when the Gear selector is in the R position and 0 Volts when in any other Gear Position.

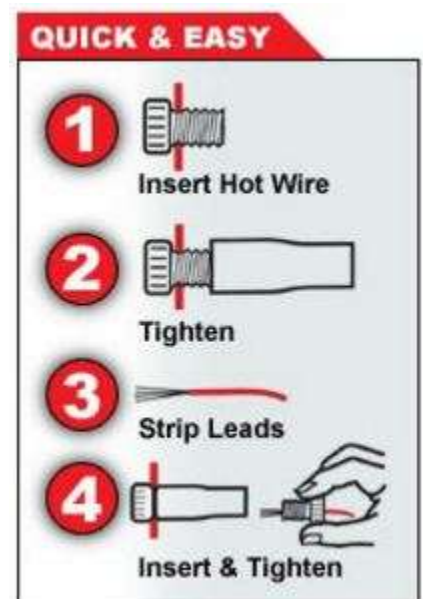



Example of 5 pin location